



# Instructions for use

First, remove the window frames. Mount the Litescreen by folding it like an umbrella. Stick it out through the window frame and then unfold. Slightly pull the unfolded Litescreen against the facade and adjust sideways until it is centered in the frame opening. Make sure that all four poles are properly fastened in the center cross, and that all rubber ends are centered in the corner pockets. Fasten the lashing strap around the center post or mount a bar on the inside of the window frame if it lacks a center post. Tighten a little and place all four wear protectors between the Litescreen corners and the facade. Finish by tightening the lashing strap. Make sure that the outer frame fits tight too. When the work is done and you are about to disassemble the Litescreen, it may be a good idea to vacuum the bottom edge first.

**The Litescreen outer dimensions are 160x210 cm (approx. 63x83 inches). Recommended maximum outer dimension of the window frame is 150x200 cm (approx. 59x79 inches).**

## Keep in mind

The Litescreen can not handle a person's weight and does not function as fall protection. If you lean out through the window frame, always wear a fall harness.

Never leave the home unattended when a Litescreen is mounted and in use.

Litescreen is for use in normal weather conditions.

When Litescreen is not in use, it should be dried, disassembled and stored in the package provided.

If Litescreen is mounted on a plaster or other fragile facade, be aware that chafing marks can occur.

**1** Make sure all parts are available.  
Aluminum poles (4 pcs), rubber ends (4 pcs), wear protectors (4 pcs), canvas (1 pcs), lashing strap (1 pcs), center cross (1 pcs).

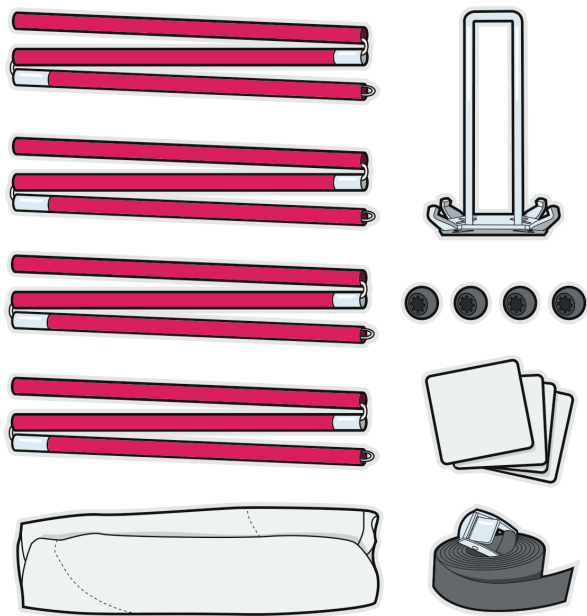

**2** Fold out the poles and attach the rubber ends.



**3** Unfold the canvas with the grey rectangle facing up.

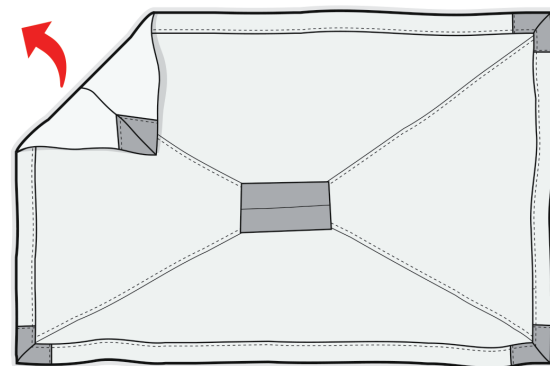

**4** Attach the lashing strap to the center cross handle.

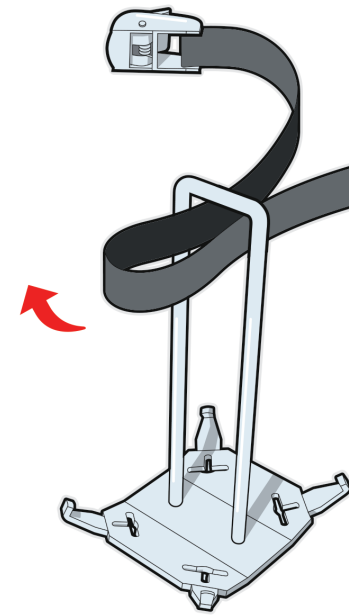

**5** Place two of the poles on the canvas and attach them to the center cross by inserting the ring into the hole from underneath and then place the pole over the bracket into load position.

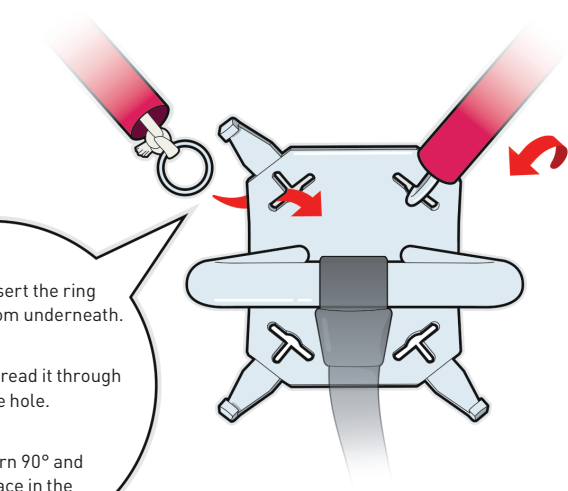
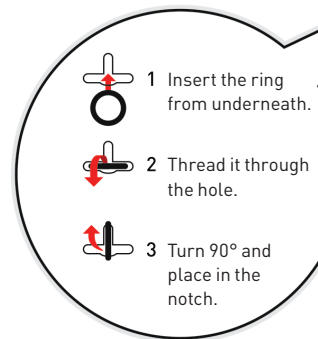

**6** If you are using a rectangular model of Litescreen then align the center cross to the grey rectangle on the canvas as displayed.

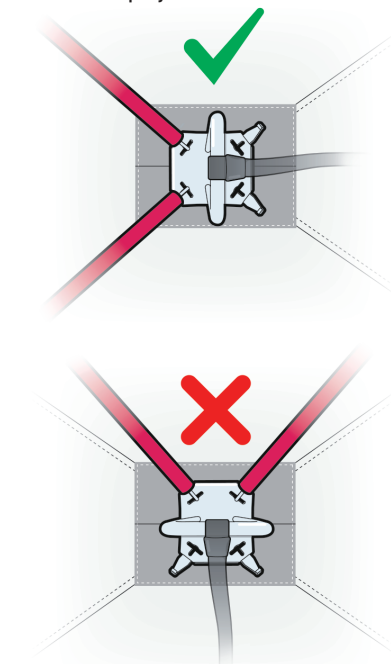

**7** Place the poles and rubber ends in the corner pockets. Secure the poles in position with the hook and loop fastener.

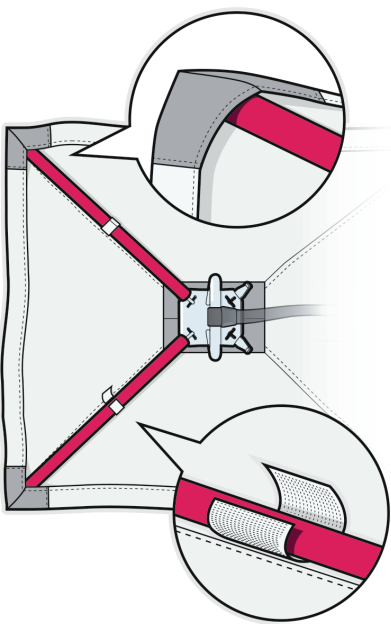

**8** Attach the two remaining poles to the center cross.

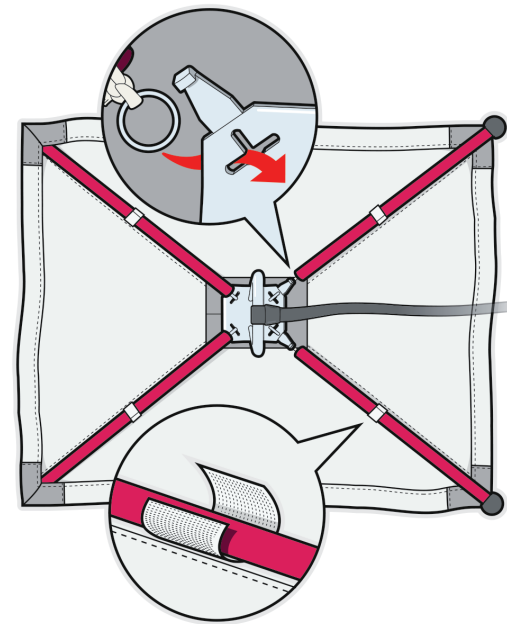

**9** Lift the poles and move them over the bracket into load position. Then pull the last two corner pockets over the rubber ends, one at a time.

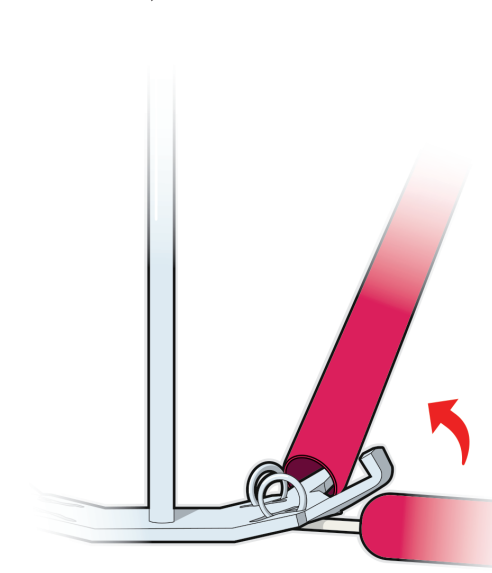

**10** Now the Litescreen is ready to use. Do not forget to use the wear protectors.

